



111 Granby Road, London

London

£220,000

# 111 Granby Road

London

Ground-floor one-bedroom flat in historic Progress Estate, Eltham. Features a large private garden, scope for improvement, and is close to shops, green spaces, and stations for central London access.

Council Tax band: C

Tenure: Leasehold

EPC Energy Efficiency Rating: D

EPC Environmental Impact Rating: D

- One-bedroom ground floor flat
- Private rear garden
- Chain-free sale
- Ideal renovation project
- Excellent transport links nearby
- Gas Central Heating







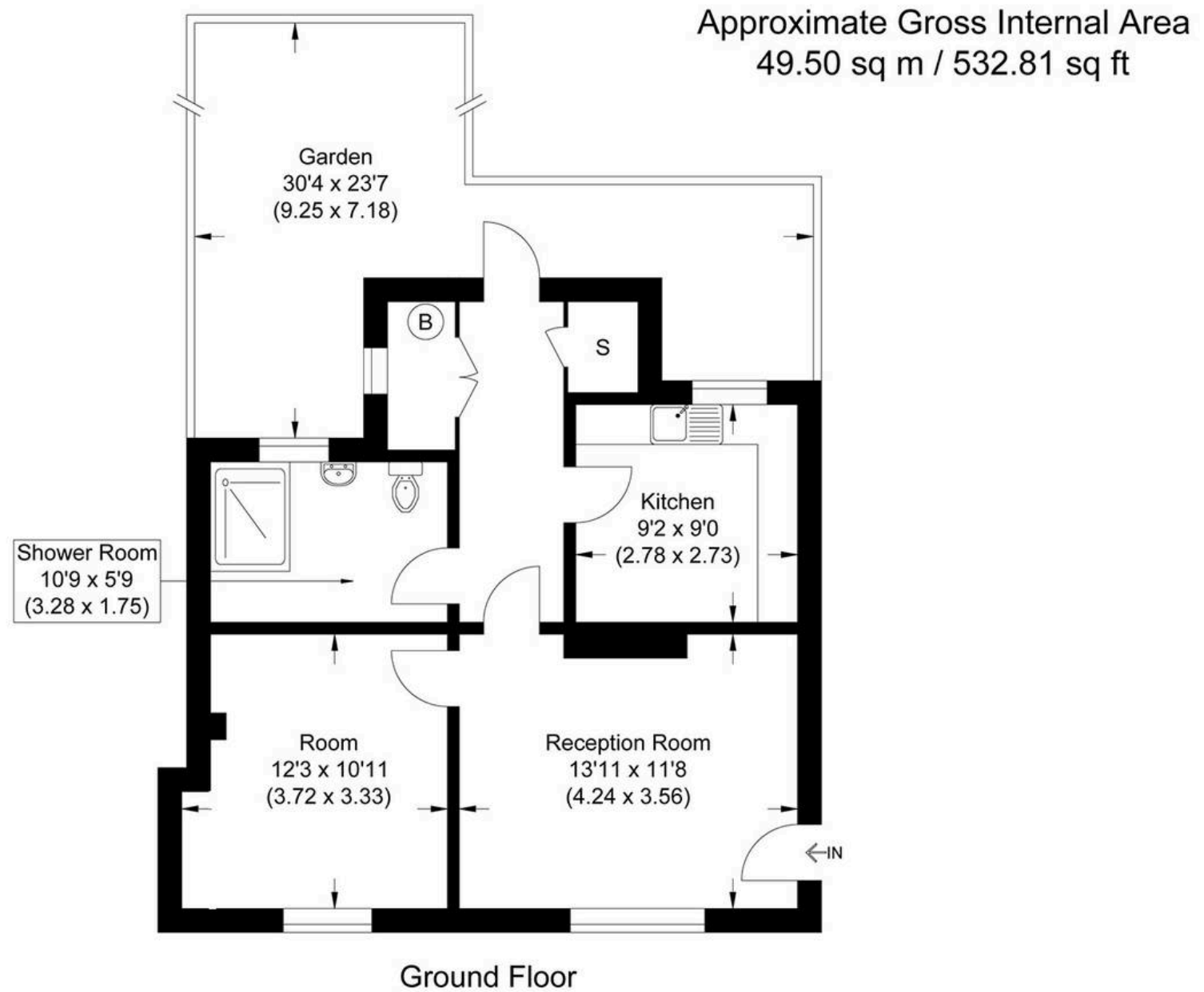

Illustration for identification purposes only, measurements are approximate, not to scale.



## MA-Residential

1st Floor Romer House, 132 Lewisham High Street, London - SE13 6EE

020 8264 4464

[hello@ma-residential.com](mailto:hello@ma-residential.com)

[ma-residential.com/](http://ma-residential.com/)