



Flat 3, 23 Vicarage Park, London

London

£190,000

Flat 3

23 Vicarage Park, London

Chain-free first-floor flat with new lease and windows, generous layout, communal garden, and great transport links. Ideal for first-time buyers seeking a project in a quiet, convenient location.

Council Tax band: B

Tenure: Leasehold

EPC Energy Efficiency Rating: C

EPC Environmental Impact Rating: B

- Chain-free
- Shared Garden
- Long lease
- Ideal renovation project
- Excellent transport links nearby
- New Windows

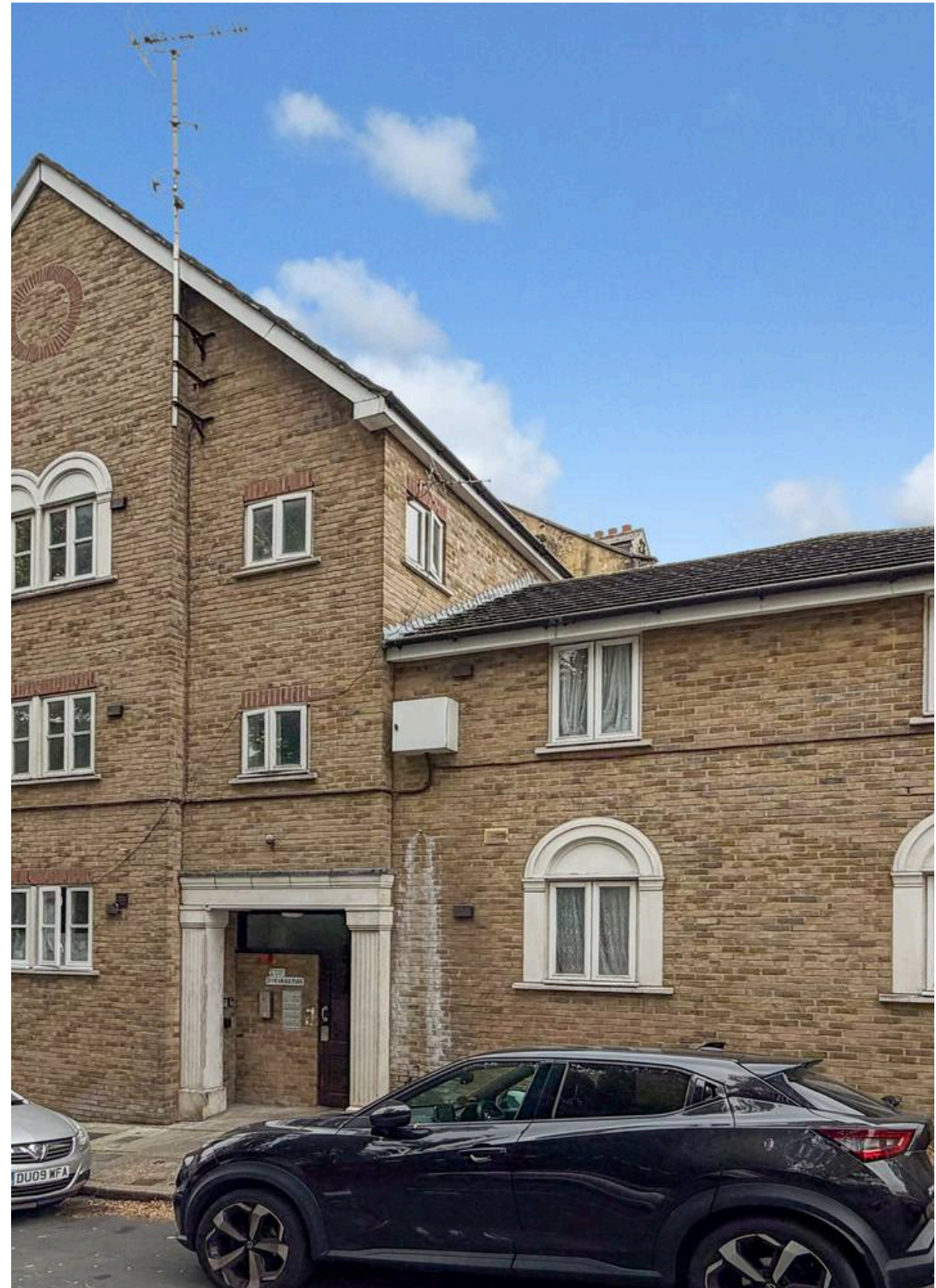







Approximate Gross Internal Area
46.16 sq m / 496.86 sq ft

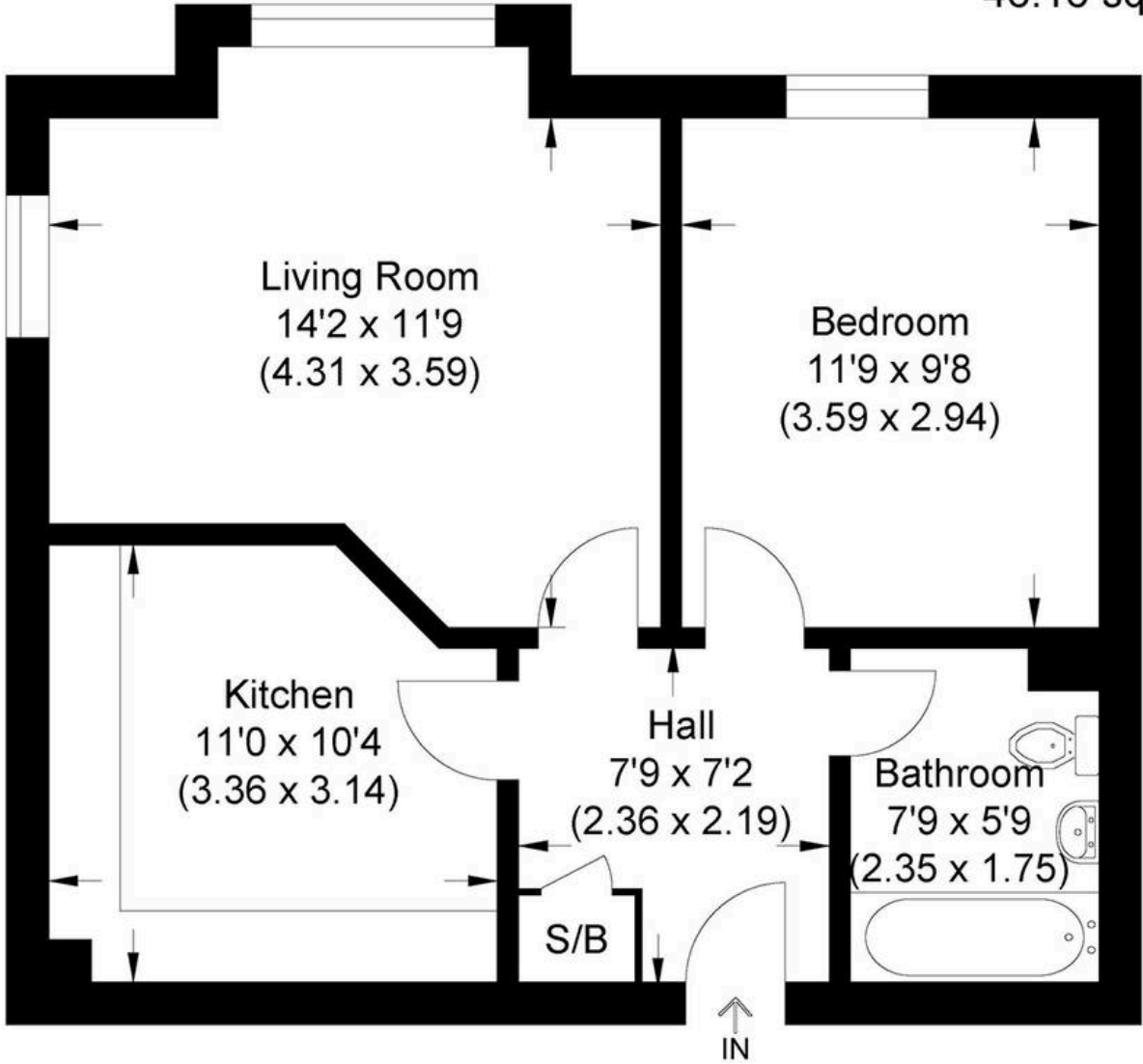

First Floor

Illustration for identification purposes only, measurements are approximate, not to scale.



MA-Residential

1st Floor Romer House, 132 Lewisham High Street, London - SE13 6EE

020 8264 4464

hello@ma-residential.com

ma-residential.com/