



Flat D, 97 Widmore Road, Bromley

Bromley

£200,000

# Flat D

97 Widmore Road, Bromley

Chain-free Victorian conversion with one double bedroom, separate kitchen, communal gardens, and storage. Requires modernisation. Close to Bromley town centre, stations, shops, and parks.

Council Tax band: C

Tenure: Leasehold

EPC Energy Efficiency Rating: C

EPC Environmental Impact Rating: C

- Chain-free
- Parking Available
- High Ceilings
- Ideal renovation project
- Excellent transport links nearby
- Gas central heating







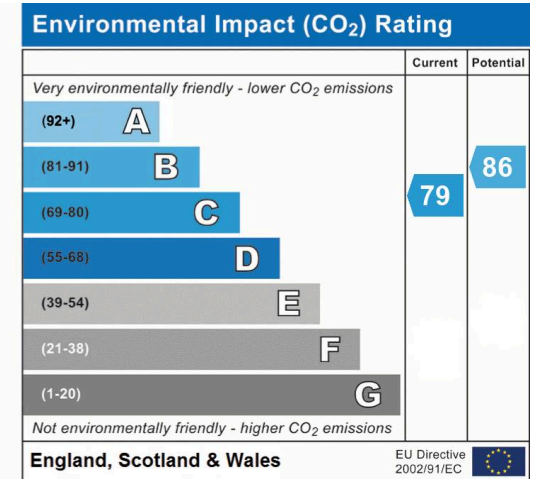
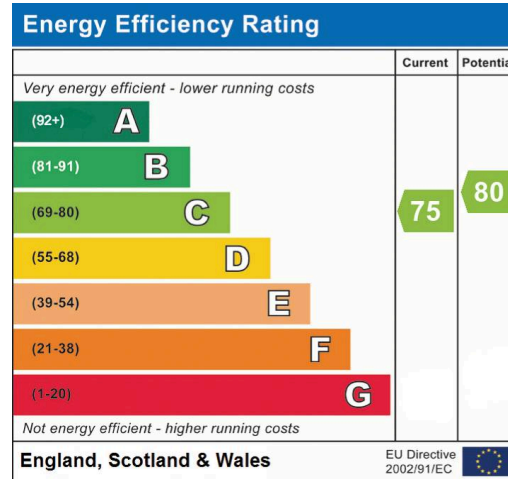

Approximate Gross Internal Area  
46.50 sq m / 500.52 sq ft

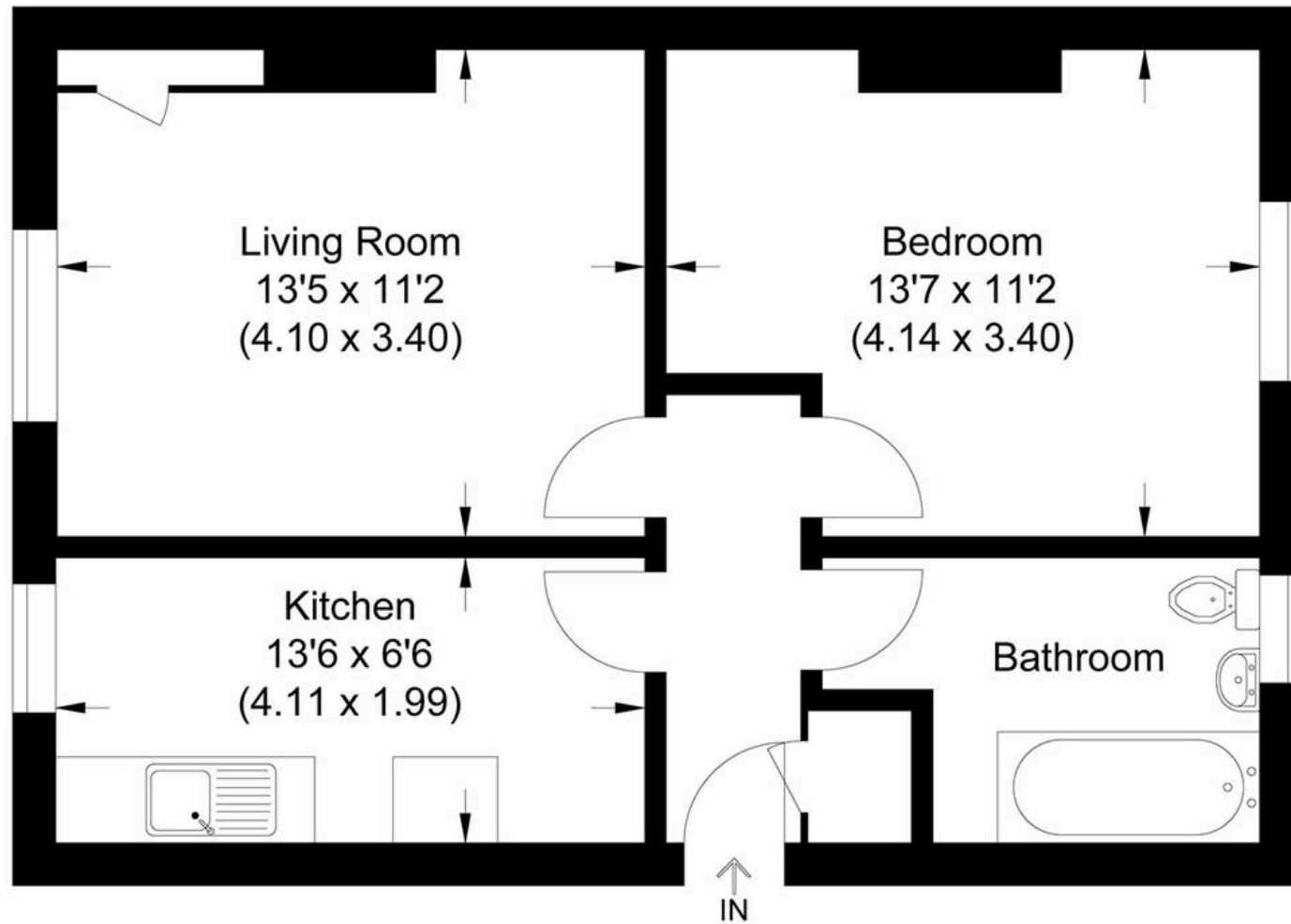

First Floor

Illustration for identification purposes only, measurements are approximate, not to scale.



## MA-Residential

1st Floor Romer House, 132 Lewisham High Street, London - SE13 6EE

020 8264 4464

[hello@ma-residential.com](mailto:hello@ma-residential.com)

[ma-residential.com/](https://ma-residential.com/)